

execTM
Care Instructions

nuna[®]

Cleaning and Maintenance

Cleaning the Seat Cover, Slip Cover, Harness Pads, and Infant Insert

Seat cover, slip cover, harness pads, and infant insert can be cleaned according to the instructions on the tag attached to the seat cover. Infant insert support wedge should be spot cleaned only.

Cleaning the Harness

The child restraint harness system cannot be removed. **DO NOT attempt to remove the harness system.**

When required, harness may be cleaned with a sponge and warm soapy water.

Towel dry excess water and allow to air dry.

Cleaning the Shell

Shell may be cleaned with a damp sponge.

Towel dry.

DO NOT use abrasive cleansers on the shell.

Cleaning the Buckle

BUCKLE CANNOT BE REMOVED.

To clean buckle, wipe with damp cloth.

DO NOT use bleach or other harsh chemicals to clean any part of the seat.

DO NOT attempt to iron the covers or pads.

Seat Cover Removal

⚠ WARNING: Do not attempt to disassemble the child restraint. Only perform steps shown in this manual.

Removing the seat cover involves removing the cover from the head support, the leg rest, and the entire child restraint.

Checklist Before Removing Seat Cover

- Raise head support to highest position (p.34)
- Loosen/unbuckle harness and chest clip (p.26).
- Remove harness pads, head insert, and infant insert (p.32–34).
- Unhook tether from back of seat (p.50).

⚠ Take care when removing head support cover so as not to damage the energy absorbing foam underneath.

Remove Head Support Cover

- 1** - Undo the snaps on the bottom of the head support cover.
- 2** - Undo the upper and lower snaps (location indicated by the four arrows) in the center of the head support cover.
- 3** - Gently pull the cover out of the retaining channel along the edge of the head support.
- 4** - Undo the snaps around the harness straps (**1**).
Slide the straps out to remove the head support cover (**2**).

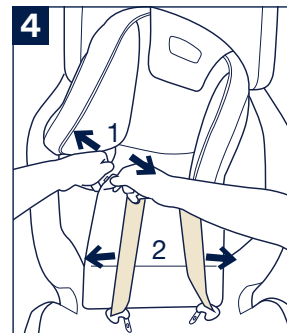
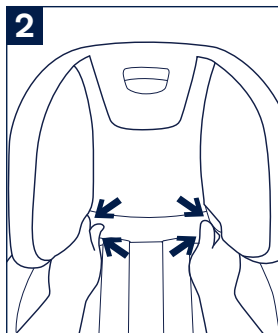
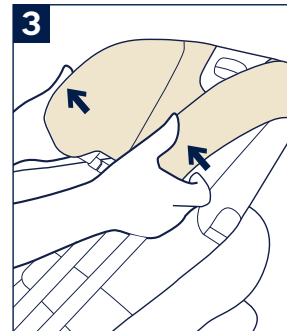
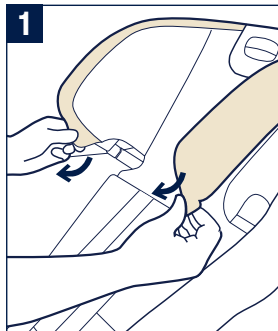

Remove Cover from Leg Rest

- 1 - Position leg rest with the bottom visible to you. Locate the four tabs on the bottom of the leg rest. Pushing each tab in the direction indicated releases a corner of the fabric-covered leg rest frame (detailed in **step 2**).
- 2 - While pushing in one of the four tabs (**1**), pull on the fabric-covered leg rest frame at the corner connected to that tab (**2**).

Tip: Start with one of the **bottom corners** and use the fabric to tug the leg rest frame until it pops out. A gentle force is necessary, so pull straight back from the leg rest so as not to bend or break the plastic tab.

Repeat for the other three corners. All four corners of the leg rest frame need to be pulled out so that the frame completely detaches from the leg rest.

- 3 - Take the removable leg rest frame out of the fabric cover and store it until you are ready to put the seat cover back on.

Tip: The easiest way to store the frame is to put it back into the leg rest without the fabric for now. Align the tabs and pop it back into place.

- 4 - Undo black hook and loop strip under leg rest.

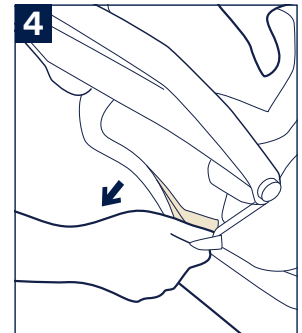
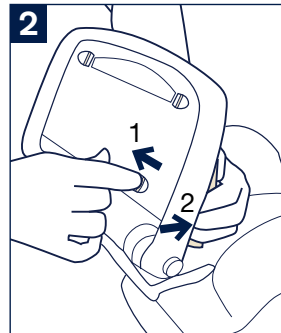
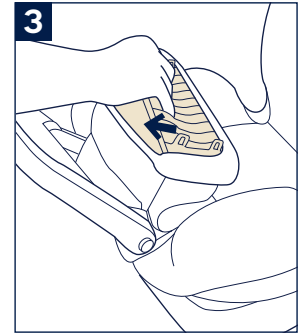
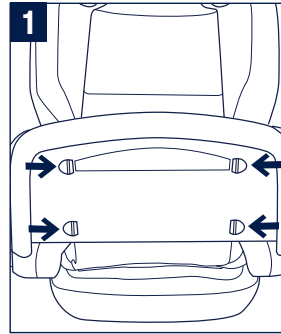

Remove Cover from Child Restraint

- 1 - Undo the snaps on the front of the seat, being careful not to damage the hidden white plastic tabs.
- 2 - Gently begin pulling the seat cover out of the retaining channel along the edge of the child restraint.
- 3 - Unsnap the lower back seat cover from the sides.
- 4 - On both sides, near the booster lap belt path, undo the snap that secures the seat cover to the inside of the seat.

Be careful not to damage the white plastic tab tucked into the retaining channel at the booster lap belt path.

- 5 - Unhook the white plastic tab from the button on the edge of the seat, near the magnetic buckle holder area.
Finish pulling the entire seat cover out of the retaining channel.
- 6 - Lower the head support to the lowest position and slide the tether strap out to completely remove the seat cover from the child restraint.

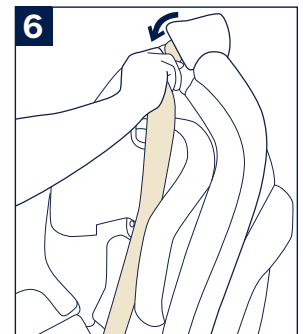
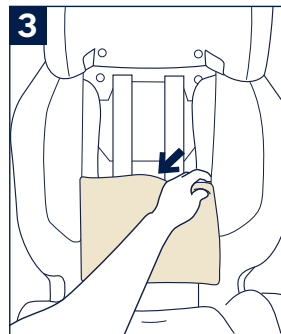
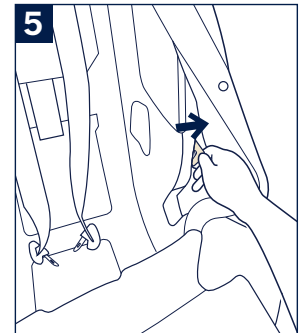
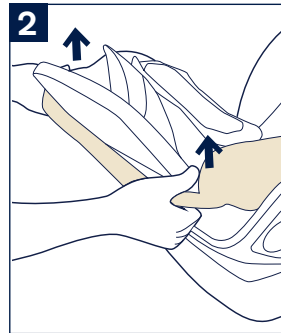
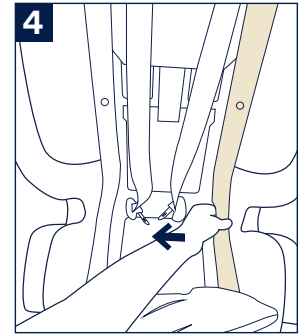
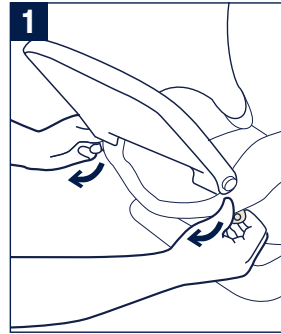

Seat Cover Assembly

Reverse steps of seat cover removal.

Assembly Checklist

- Leg rest cover is secured around the leg rest frame, and the frame is secured back inside the leg rest.
- The hook and loop closure under the leg rest is attached.
- All snaps are attached.
- The harness buckle, harness adjustment strap, and tether strap are routed through the seat cover.
- The white plastic tabs on either side of the seat cover are folded under the fabric before the fabric is tucked into the retaining channel.
- The edge of the seat cover is tucked into the retaining channel along the edge of the seat.
- The edge of the head support cover is tucked into the retaining channel along the edge of the head support.

©2019 Nuna Baby Essentials, Inc. Nuna and all associated logos are trademarks.